

CIRCLE OF SUPPORTERS
MEMBERSHIP FORM

Name _____

Street _____

City _____ Zip _____

Telephone _____

Make checks payable to:
Animals for Education

Mail to:
Critter Creek Wildlife Station
36710 Sand Creek Road
Squaw Valley, CA 93675

Membership Categories	Annual Dues
Student	\$ 10
Senior	\$ 15
Individual	\$ 25
Family	\$ 40
Sponsor	\$ 100
Patron	\$ 250
Corporate or Life	\$ 1000

Members receive our quarterly newsletter



Newsletter of Critter Creek Wildlife Station Fall 2007 Volume 12, No. 3

BUSY YEAR AHEAD

For the next twelve months, Critter Creek will be working to expand and update existing caging. Many of our cages are over twenty years old, so rotting wood and rusty cage wire is becoming an issue and has to go. We have found partial funding for some of the projects; however, many still need additional funds before we can begin construction. Virtually all of these projects will require volunteer work crews to complete. If you are interested in working on a specific project, please contact us at 338-2415 for more details.

THE HERON AND EGRET ENCLOSURE

The extension of Web-Foot Wash is just beginning. This is an area connected to the waterfowl enclosure that will have shallow ponds better suited for our resident heron, Mr. Blue and egret, Betty White. This area will also serve as a conditioning cage for our shore-dwelling birds. We have seen an increase in young bitterns, egrets, and herons of all types coming into Critter Creek. Some are young and others are injured adults. We would like the area to be large enough to allow some flight practice—20X40X10. The shallow ponds in the heron/egret area will be the start of the bio-filter cycle. These ponds will contain plants and fish that will help remove excess nutrients from the water. The pools will flow into Web-Foot Wash where the water is pumped through the bio-filter system and back into the heron/egret area. The system is chemical-free and relies on nature's systems for cleaning up the water. This project is currently underway. Again we must do the construction ourselves, so any volunteers are appreciated.



20' x 40' x 10' chain link and shade cloth top

Critter Creek Chronicle

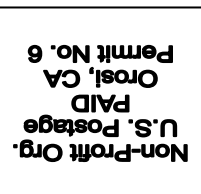

SHASTA'S ADULT ENCLOSURE

Shasta, our resident adolescent mountain lion, has been growing day by day and is demanding more space. He leaps from his platform to the other side of his cage in a single bound. Now that Web-Foot Wash is nearly completed and the arena residents moved, we are ready to begin Shasta's new cage. It will be 60X50X10. It will be constructed of welded bull fence panels. The cage will have a boulder pile den system, a pond (since we know how much he loves water in the summer) and a tree for climbing and snoozing. We have received some donations for the materials, but this is the kind of cage that requires some major funding. Strength of the fencing panels, safety requirements, and environmental enrichment features, all add to the expense of the project. To hold expenses down, Critter Creek's volunteers will be constructing this cage. To do this we are scheduling several "work weeks."

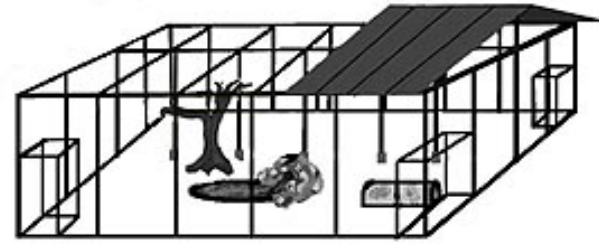

- One week we are trying to line-up welders to help us weld fence panels.
- Another week we need volunteers to help weld the pole framework and set it in place.
- A final week, we need volunteers to attach the roof and siding fence panels to the framework.

INTERMEDIATE HAWK FLIGHT CAGE

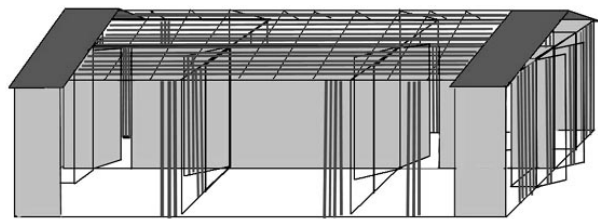

A new project that has been funded is our new intermediate hawk flight cage. Red shouldered, Cooper's, and sharpshinned hawks among others are typically more hyper than red-tailed hawks and Swainson's hawks, so they have special caging needs. The last few years, we have been getting increasing numbers of red-shouldered hawk babies. They do well hunting along rivers and seasonal creeks. We have a wild resident pair

that nest at Critter Creek each year. They and their young delight visitors with their shrill and staccato calls. This new flight cage will be 60X24X16 and will use materials to protect the hawks from harm. The funding is for materials only, so we can use help in construction—start of construction should be some time in January.

CORVIDS FLIGHT CAGE

Also in January we will be building a new corvid enclosure to house crows and ravens. Corvids are incredibly smart and social. The flight cage will accommodate their natural instincts to explore and interact. We will have a separate section for the young, which will allow us to introduce them slowly into the adult population. In addition, we will have a section for recovering adults who are not yet ready to function in a group or what is called a "murder" of crows.

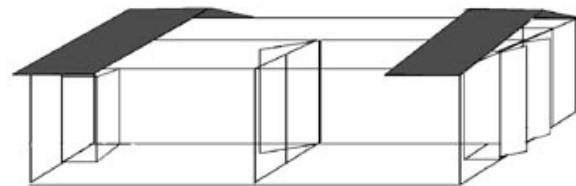

SMALL OWL CAGE

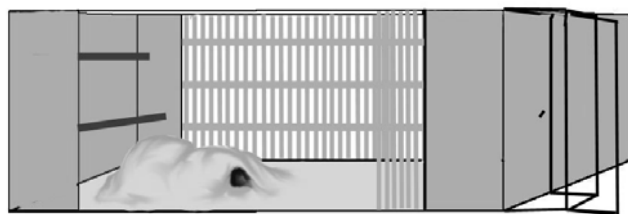

We have received funding for a new small owl enclosure to replace our current ancient cage. This enclosure will house screech owls, burrowing owls and orphaned owlets. It will have a mound with underground condos for the burrowing owls and tree limbs and hollows for the screech owls. Again the funding is only for the materials,

so we will need help from volunteers in the construction phase.

TRI-CAT ENCLOSURE

Plans are in the works for a new enclosure for the three exotic cats we acquired: Achilles, a Siberian lynx; Simba, a caracal; and Zeke, a serval. The new design will allow us to house them in separate areas where each can be his own cat and eat in solitude. However since they were raised together, they enjoy playing together, so the new enclosure also has a common play area in order to accommodate social interaction.

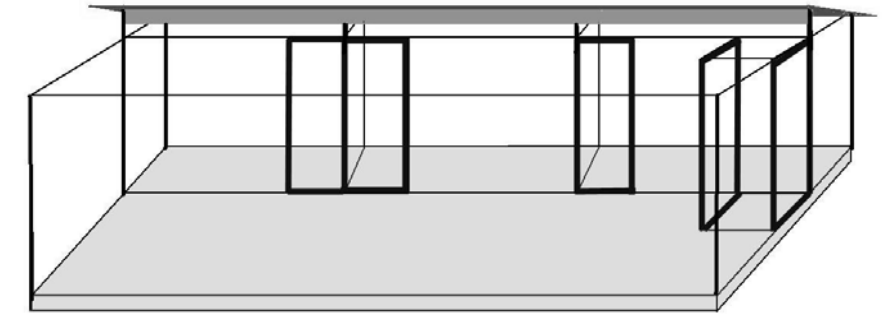

RACCOON RENOVATION

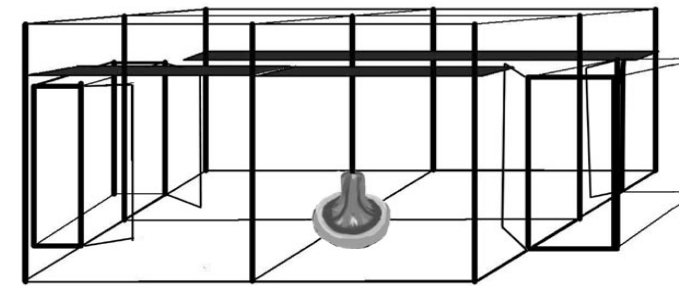

Plans are also in the works for new digs for the permanent raccoons of Critter Creek: Bandit, Rayne, Jasmine, and Darby. These raccoons came to us as surrendered or confiscated pets. Once adults, they often become difficult to handle. They have not been socialized to other raccoons and so are poor candidates for release. They are very likely to approach humans for food and lacking the natural fear of people, are likely to bite someone if their demands are not met. We will be renovating an existing

enclosure to better house our permanent imps. The renovated enclosures will make it easier to maintain their health. These enclosures will also give them more room to play, explore, and interact.

ANIMAL RELEASE NEWS



Our volunteers do a lot of work throughout the year, and recently they have been busy releasing the rehabilitated and orphaned animals.



OPEN HOUSE

Saturday, October 20th -- 11:00 a.m. to 2:00 p.m.

Last tour begins at 1:30 p.m.

